

BIOWARMER PELETS/WOOD CHIPS SPECIFICATIONS SHEET

BIOWARMER PELETS



Biowarmer is a steel, one function boiler. It is a multifuel device with automatic feeding system, designed to burn biomass. Biowarmer can be installed in both boiler rooms new and retrofit to automate the process of burning, improve ease of use as well as due to the reduction of harmful emissions gas into the atmosphere.

FUEL

Recommended fuels:

- sawdust biomass in the form of pellet having a diameter of 6 to 10mm and 50mm



length.

The calorific value should not be less than 18MJ/kg and the humidity should not exceed 10%.

- wood chips with maximum dimensions of 30 mm.

Alternative fuels for Biowarmer Pelets/Wood chips:

- stones cherries

TABLE SPECIFICATIONS

| Model | | | Biowarmer | Biowarmer | Biowarmer | Biowarmer | Biowarmer | Biowarmer | Biowarmer |
|---|-----------------------------------|-------------------|--|-----------|-----------|-----------|-----------|-----------|-----------|
| Power Range | sawdust briquette | | 25 | 50 | 75 | 100 | 150 | 200-250 | 300-350 |
| Efficiency | | % | | 82-91 | | | | | |
| Water capacity | | dm ³ | 120 | 190 | 260 | 360 | 470 | 1600 | 1820 |
| Max working pressure | | bar | 2 | | | | | | |
| Min. outlet temperature | | °C | 65 | | | | | | |
| Min. Outlet temperature | | °C | 90 | | | | | | |
| Fluegases temperature at nominal power | | °C | 180-340 °C | | | | | | |
| Fluegases temperature at minimal power | | °C | 100-140 | | | | | | |
| Boiler Class PN-EN – 303-5 | | | 5 | | | | | | |
| Water-side resistance; Δt=10K | | mbar | 2+20 | | | | | | |
| Water-side resistance; Δt=20K | | | 0,5+5 | | | | | | |
| Chimney pressure | | Pa | 15-20 | 20-25 | 20-25 | 25-30 | 25-30 | 25-30 | 30-35 |
| Recommended chimney height | | m | 8 | 8 | 8-10 | 8-10 | 12 | 14 | 14 |
| Recommended chimney section | | cm ² | 400 | 400 | 600 | 600 | 600 | 1500 | 1500 |
| Fuel tank capacity | | dm ³ | The an individual order of 1.15 to mm3 | | | | | | |
| Fuel consumption | Nominal Power: sawdust briquettes | kg/h | 6,9 | 13,8 | 20,7 | 27,6 | 41,4 | 55,2 | 82,9 |
| Approximate working time at one load | | h | 51,2 | 25,6 | 31,1 | 23,3 | 15,6 | 11,7 | - |
| Power consumption (for. since version) | | W | 850 | 850 | 850-2250 | 850-2250 | 850-2250 | 850-2250 | 850-2250 |
| Powerconsumption of the heater (optional) | | W | 400 | | | | | | |
| CO Emission (O2=10%) | | mg/m ³ | 2100-2610 | | | | | - | |
| OGC Emission (O2=10%) | | mg/m ³ | 85-94 | | | | | - | |
| Dust Emission (O2=10%) | | mg/m ³ | 95-130 | | | | | - | |

Construction of the biomass combustion in the boiler Biowarmer Pelets/Wood chips

Installation of the fuel tank for the boiler

Futura Biowarmer is performed on individual orders adjusting capacity and dimensions to customer needs.

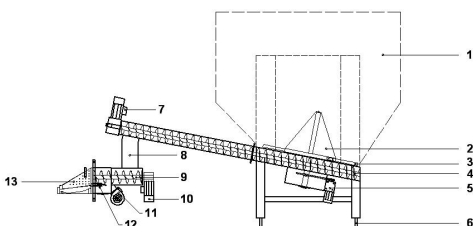

1. Fuel tank
2. Mixer
3. Mixer blades
4. Feeder
5. Mixer motor gear
6. Height regulation
7. Feeder motor gear
8. Chuke connector
9. Feeder burner
10. Feder motor gear
11. Fan
12. Igniter
13. Burner with iron grate



In options there is also the possibility of making an automatic ash removal.

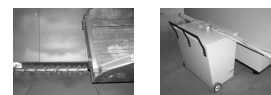

BIOWARMER PELETS/WOOD CHIPS SPECIFICATIONS SHEET

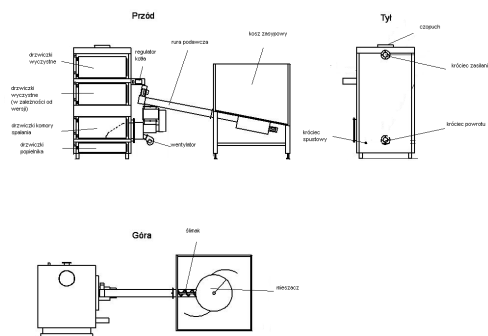

BIOWARMER Pellet 25, 50

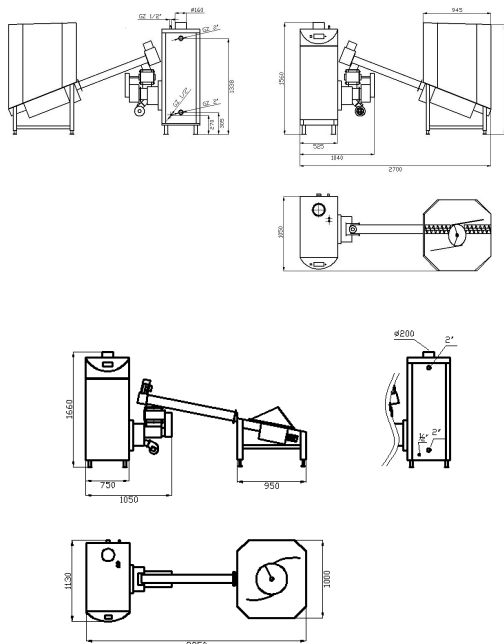

BIOWARMER Pellet 75, 100

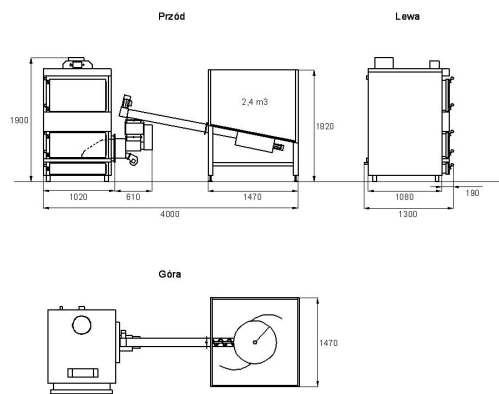
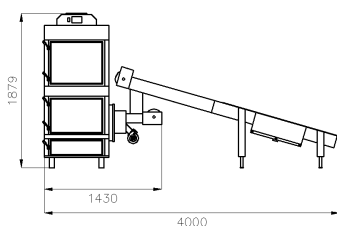

BIOWARMER Pellet 150

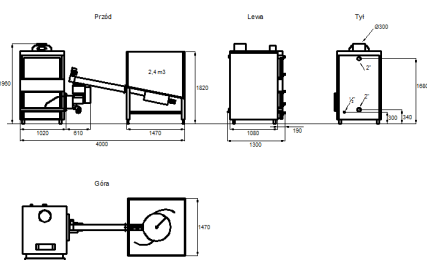

BIOWARMER Standard 250, 300-350

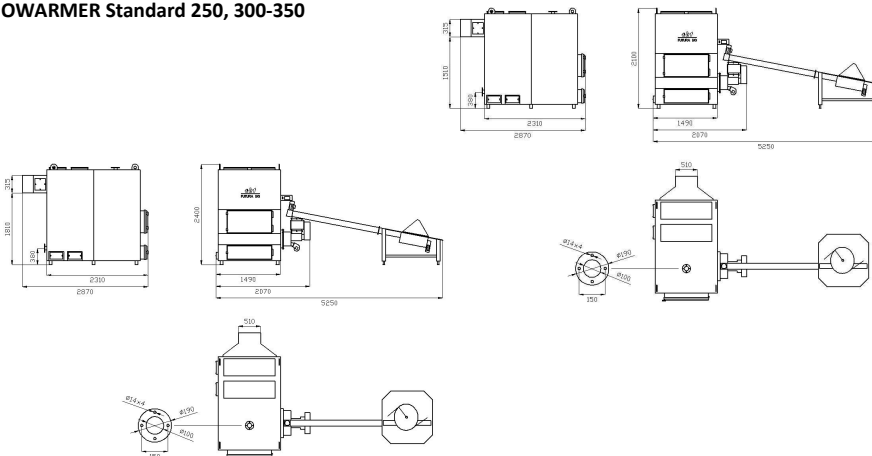

AUTOMATION



RK2006 LPG

Supports the feeder, fan, domestic hot water pump and central heating pump and cooperates with a room thermostat. It has a double thermal protection, autodiagnostic system and total bacteria control process in hot water tank

ADVANTAGES OF THE THE BOILER

- Automatic combustion control
- Electric ignition
- Large fuel tanks
- Possibility to arrange your own tank
- Can be installed ash removal system

